

Hawaii

CONDOMINIUM GUIDE

NOW ONLINE

Hawaii Information Service is taking Hawaii's condo guide to new heights. Now you can get current and complete information on condominium projects across the state online!

Photos & Data

COLONY BEACH

Isle/District	OAHU/DIAMOND HEAD	Bldg P
Address	2893 KALAKAUA AVE HONOLULU, HAWAII	Compl
Public Report #	318	Conve
Prelim Date	//	Fee O
Final Date	02/25/70	Lesso
Suppl Date	//	Lease
Land Area	53445F	Years
Zoning	APT-HTL	First P
Tenure	FEE	Seco
Recore Sys	RS	Third I
Condo Map #	159	
Attorney	STUART T K HO	Elem 5
Architect	ROBERT PANG	Middle
Developer	COLONY SURF DEV CORP	High 5

- ✳ Expanded data sheets, floor plans and plot plans wherever available
- ✳ Current photos for most projects
- ✳ Redrawn plans are easier to read
- ✳ Easily print, e-mail, and share information, or incorporate it into your own presentations.

Plot & Floor Plans

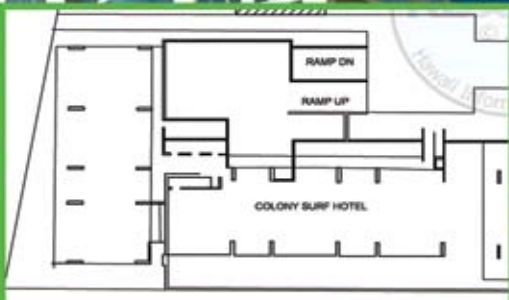

Unit Plans



HawaiiInformation.com/condoguide
Sales@HawaiiInformation.com
(808) 748-8751